

SPARE PARTS

200 Series

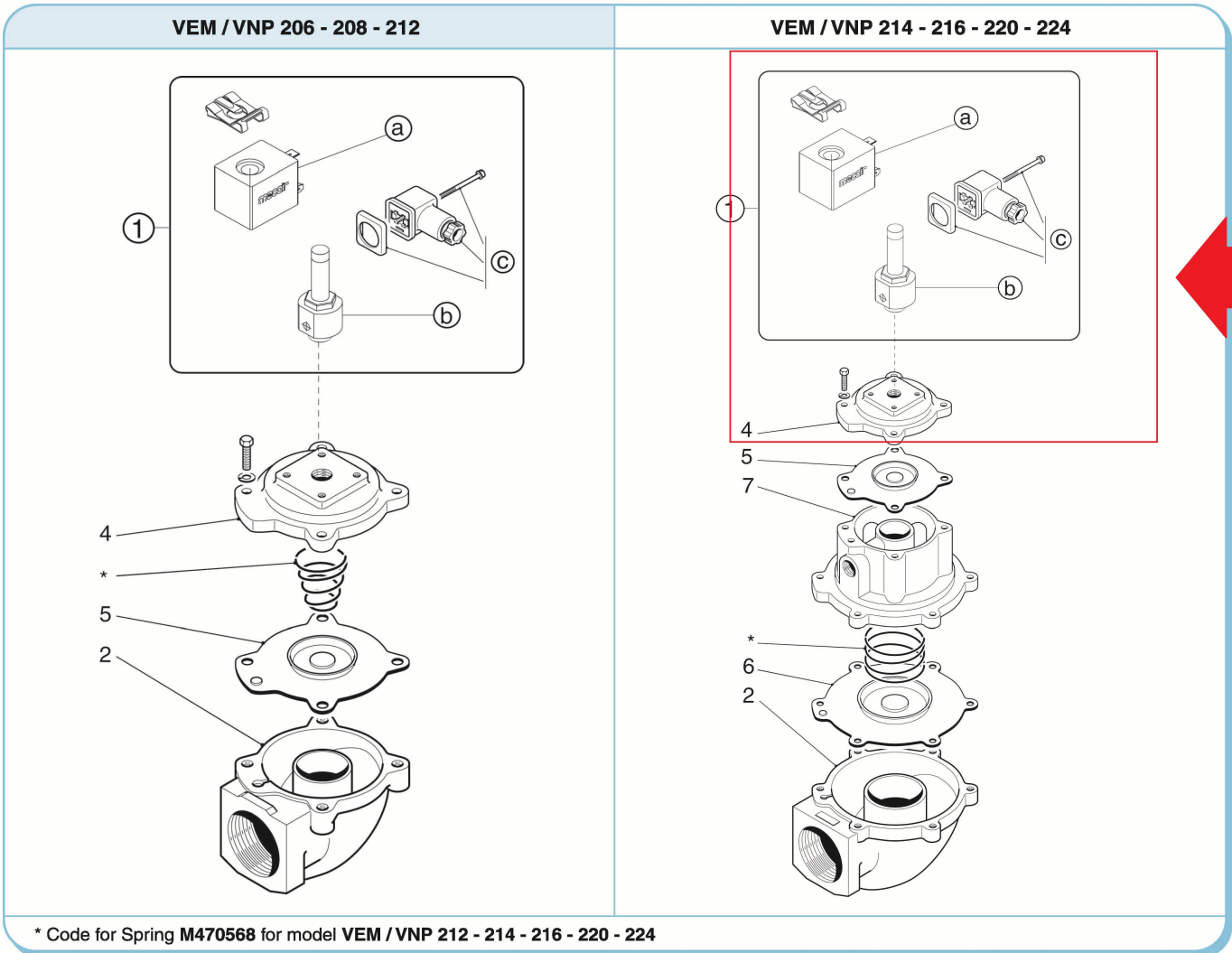

\* Code for Spring M470568 for model VEM / VNP 212 - 214 - 216 - 220 - 224

STANDARD Version

OPTIONAL Version

Standard	POS	DESCRIPTION	CODE
1	a)	Solenoid (*)	a) SB3 - ../.. (*)
	b)	Pilot group complete with base and ferrule	b) CP1/4
	c)	Din Connector PG9EN175301-803 IP65	c) PLG9

(\*) Specify Voltage and Frequency

Optional	POS	DESCRIPTION	CODE
1		Solenoid (*)	a) SB3 - 24/DCX
	b)	Pilot group complete with base and ferrule	b) CP1/4
	c)	Din Connector (3GD IP65 T6)	c) PLG9 - ATEX

Version in conformity to European Directive 94/9/CE ATEX (cod. PV-24/DCX)

POS	DESCRIPTION	CODE							
		VEM/VNP206	VEM/VNP208	VEM/VNP212	VEM/VNP214	VEM/VNP216	VEM/VNP220	VEM/VNP224	
1	Pilot group complete with solenoid (*) and din connector	PV - ../.. (*)	PV - ../.. (*)	PV - ../.. (*)	PV - ../.. (*)	PV - ../.. (*)	PV - ../.. (*)	PV - ../.. (*)	
1+4	Pilot group complete with solenoid (*), din connector, top cover and screws	PVM06 - ../.. (*)	PVM08 - ../.. (*)	PVM12 - ../.. (*)	PVM06 - ../.. (*)	PVM06 - ../.. (*)	PVM06 - ../.. (*)	PVM08 - ../.. (*)	
2	Valve Body	M300201	M300204	M300211	M300211	M300218	M300222	M300237	
7	Intermediate cover (Double diaphragm)	-	-	-	M310098	M310100	M310101	M310102	
4	Top Cover	M310082	M310086	M310092	M310082	M310082	M310082	M310086	
5	Diaphragm	DB 16	DB 18	DB 112	DB 16	DB 16	DB 16	DB 18	
6	Diaphragm (Secondary)	-	-	-	DB 114	DB 116	DB 120	DB 124	

(\*) Specify Voltage and Frequency